

Nursery Close Planting Plan



1:200

Nursery Close Plant Schedule

Trees Species	Number
Fraxinus excelsior 'Altena'	4 No.
Quercus robur	2 No.
Carpinus betulus 'Frans Fontaine'	7 No.
Sorbus aucuparia 'Fastigiata'	3 No.
Carpinus betulus	12 No.
Fagus sylvatica	137 No.
Fagus sylvatica 'Purpurea'	42 No.

Shrubs Species	Number
Hebe rakaiensis	52 No.
Hypericum x moserianum	34 No.
Salix lanata	41 No.
Lavandula angustifolia 'Hidcote'	69 No.
Symphoricarpos x chenaultii 'Hancock'	57 No.
Viburnum davidii	46 No.
Rosa 'The Fairy'	29 No.
Cotoneaster dammeri	17 No.
Cornus alba 'Sibirica'	38 No.
Prunus laurocerasus 'Otto Luyken'	9 No.
Photinia x fraseri 'Red Robin'	7 No.
Cytisus x praecox 'Allgold'	7 No.

Herbaceous Species	Number
Hosta sieboldiana	22 No.
Convallaria majalis	32 No.
Bergenia cordifolia	27 No.
Hosta fortunei 'Albopicta'	25 No.
Grasses Species	Number
Deschampsia cespitosa	19 No.
Carex comans 'Bronze'	34 No.

Nursery Close Access Design

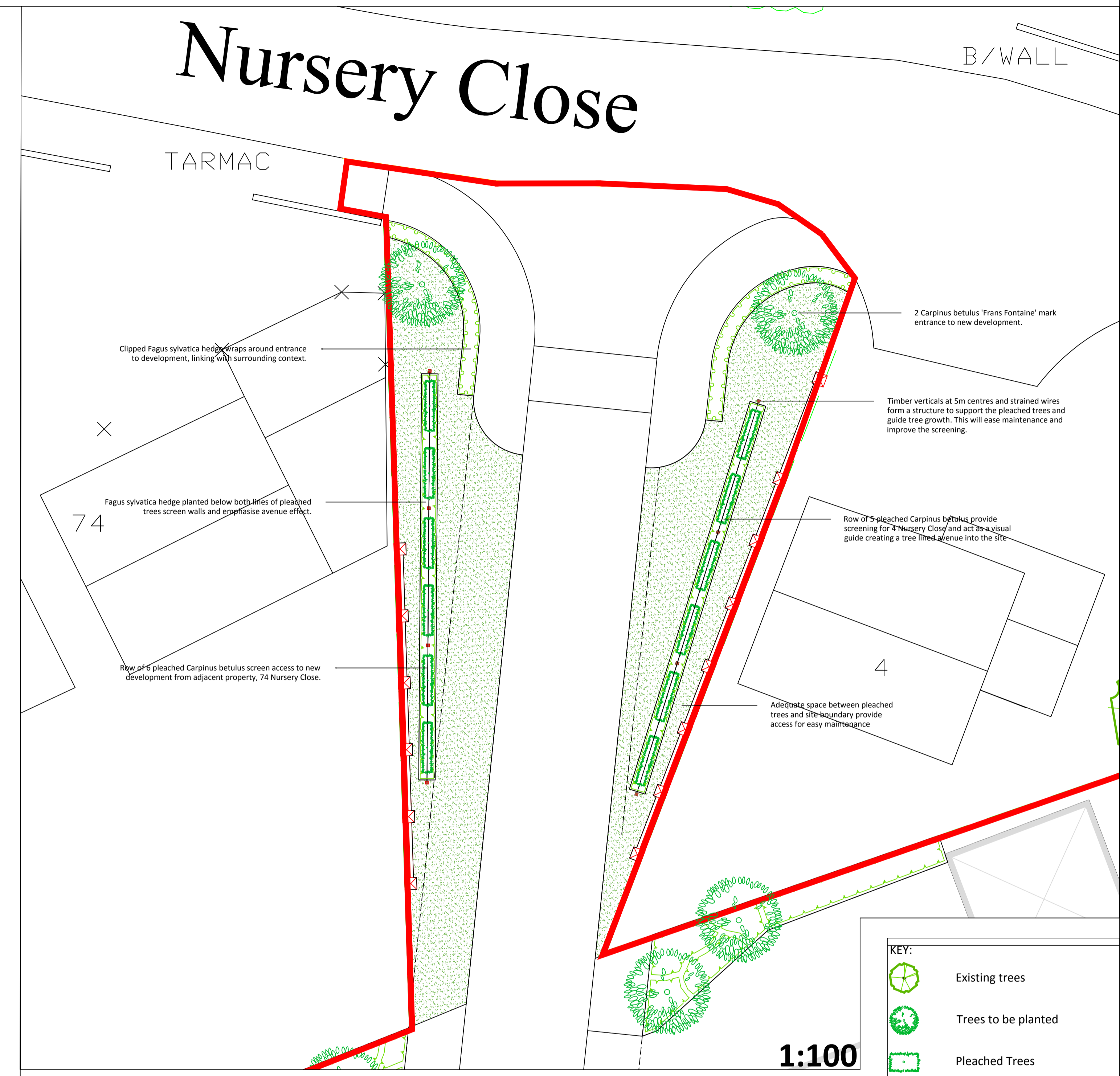

1:100

Entrance Planting Elevation

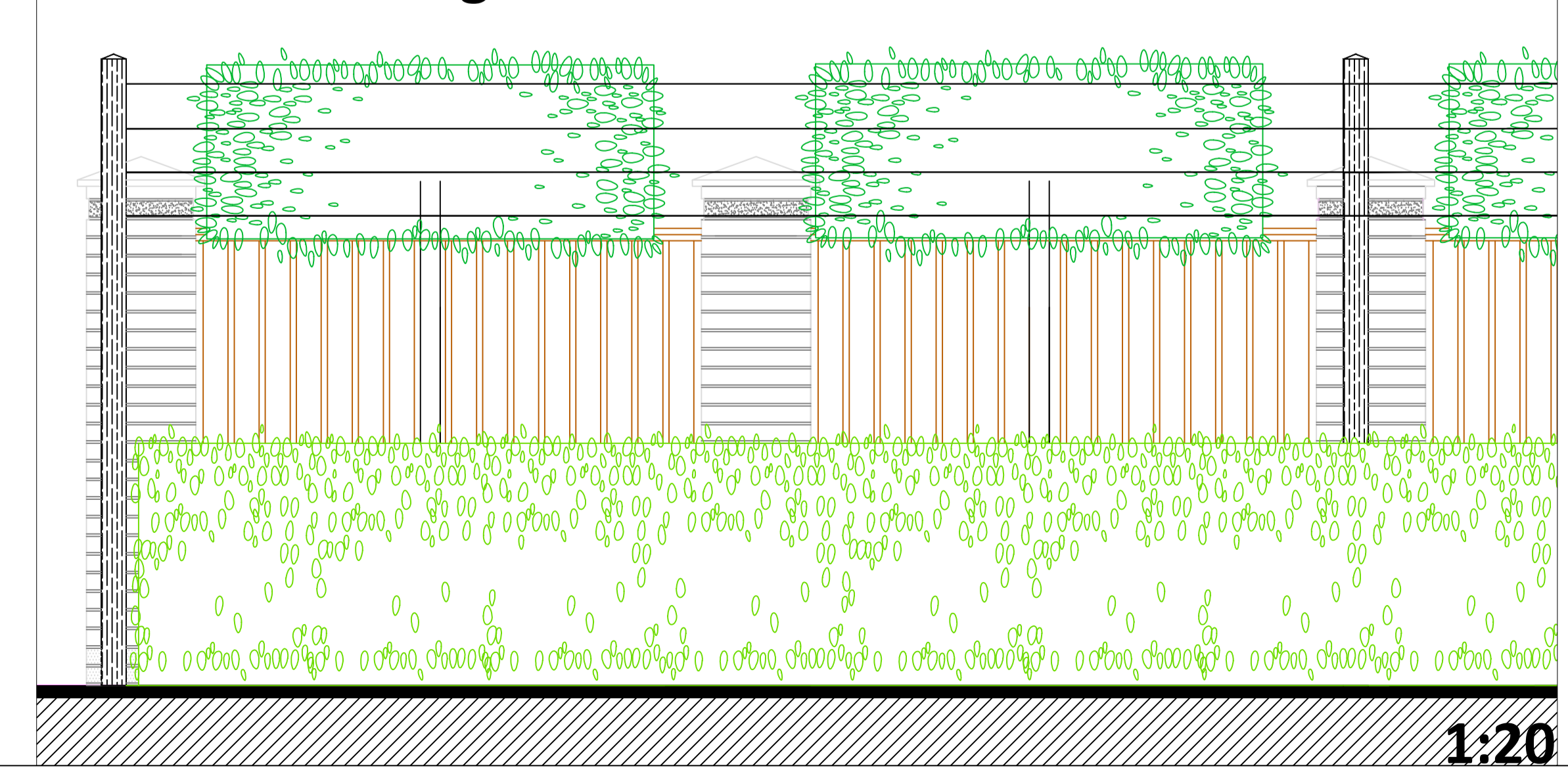

1:20

KEY:

- Existing trees
- Trees to be planted
- Pleached Trees
- Shrub/Perennial planting
- Clipped Beach Hedge

WOOLERTONDODWELL
Landscape Architecture & Environmental Planning

Mossion House, 4 Fenton Street
LANCASTER, LA1 1TE
Telephone: 01524 842000
Email: admin@woolertondodwell.co.uk
Website: www.woolertondodwell.co.uk

Project:
Nursery Close, Charnock Richard

SOFTWORKS LAYOUT PLAN

Drawing No. 644.C.01	Date: 05/12/2011	Scale: VARIOUS
Drawn By: CW	Checked by: DB	